

**TO BE FILLED BY THE INSPECTING OFFICER**  
**(ASSISTANT ENGINEER)**

1. Name of Officer : Mohamed Mubaris. K
2. Name of School : Salahudheen Ayyoobi English School
3. Location/with name of Education  
District/Sub District : Parakkulam/Ottappalam/Thrithala
4. Classification of building and size : Attached  
All buildings are POST KER, Class room dimensions attached with this document
5. Period of which the certificate issued : 2024-2025
6. Nature of defects if any
  - a) Foundation and basement : Nil
  - b) Superstructure : Nil
  - c) Doors & windows : Nil
  - d) Wood work wrought and put up : Nil
  - e) Roof : Nil
  - f) Flooring : Nil
  - g) Miscellaneous (cracks etc) : Nil
7. Any major defects noticed which will  
Render the building unsafe in any manner: Nil
8. Whether maintenance works have been  
Done properly : Yes
9. Whether the structure is sound on for  
Conducting classes : The Structure is sound for conducting classes  
under normal weather condition.

Note: 1. The stability of the structure should be examined also with reference to location, Attitude, intensity of wind, exposure to flood etc.  
2. Any additional observations if deemed necessary for the certificate may be furnished separately with the certificate.

Certified that the school was inspected by me on 4/06/2024 and found to be fit to conduct classes for the period 2024-2025 for the reasons noted above.

Place: Kumaranellur

Date: 5/06/2024

Signature:



Designation:

**MOHAMED MUBARIS. K**  
PEN: 949265  
Assistant Engineer  
LID & EW Section  
Kappur Gramapanchayath



SALAHUDEEN AYYOUBI ENGLISH SCHOOL BLOCK G BUILDING



BLOCK -G- GROUND FLOOR PLAN

AREA CALCULATION

BLOCK NAME	FLOOR	CLASS ROOM SIZE (cm)	AREA (Sqm)	HEIGHT	NO CLASS ROOMS	TOTAL AREA (Sqm)
BLOCK A	GROUND FLOOR	8000x4000	32.00	3.10	1	32.00
BLOCK A	FIRST FLOOR	8000x4000	32.00	3.10	1	32.00
BLOCK A	SECOND FLOOR	8000x4000	32.00	3.10	1	32.00
BLOCK A	THIRD FLOOR	8000x4000	32.00	3.10	1	32.00
BLOCK A	GROUND FLOOR	6000x4000	24.00	3.10	1	24.00
BLOCK A	FIRST FLOOR	6000x4000	24.00	3.10	1	24.00
BLOCK A	SECOND FLOOR	6000x4000	24.00	3.10	1	24.00
BLOCK A	THIRD FLOOR	6000x4000	24.00	3.10	1	24.00
BLOCK B	GROUND FLOOR	4000x4000	16.00	3.10	1	16.00
BLOCK B	FIRST FLOOR	4000x4000	16.00	3.10	1	16.00
BLOCK B	SECOND FLOOR	4000x4000	16.00	3.10	1	16.00
BLOCK B	THIRD FLOOR	4000x4000	16.00	3.10	1	16.00
BLOCK C	GROUND FLOOR	4000x4000	16.00	3.10	1	16.00
BLOCK C	FIRST FLOOR	4000x4000	16.00	3.10	1	16.00
BLOCK C	SECOND FLOOR	4000x4000	16.00	3.10	1	16.00
BLOCK C	THIRD FLOOR	4000x4000	16.00	3.10	1	16.00
BLOCK D	GROUND FLOOR	4000x4000	16.00	3.10	1	16.00
BLOCK D	FIRST FLOOR	4000x4000	16.00	3.10	1	16.00
BLOCK D	SECOND FLOOR	4000x4000	16.00	3.10	1	16.00
BLOCK D	THIRD FLOOR	4000x4000	16.00	3.10	1	16.00
BLOCK E	GROUND FLOOR	4000x4000	16.00	3.10	1	16.00
BLOCK E	FIRST FLOOR	4000x4000	16.00	3.10	1	16.00
BLOCK E	SECOND FLOOR	4000x4000	16.00	3.10	1	16.00
BLOCK E	THIRD FLOOR	4000x4000	16.00	3.10	1	16.00
BLOCK F	GROUND FLOOR	4000x4000	16.00	3.10	1	16.00
BLOCK F	FIRST FLOOR	4000x4000	16.00	3.10	1	16.00
BLOCK F	SECOND FLOOR	4000x4000	16.00	3.10	1	16.00
BLOCK F	THIRD FLOOR	4000x4000	16.00	3.10	1	16.00
BLOCK G	GROUND FLOOR	4000x4000	16.00	3.10	1	16.00
BLOCK G	FIRST FLOOR	4000x4000	16.00	3.10	1	16.00
BLOCK G	SECOND FLOOR	4000x4000	16.00	3.10	1	16.00
BLOCK G	THIRD FLOOR	4000x4000	16.00	3.10	1	16.00
<b>TOTAL</b>			<b>41.34</b>	<b>3.10</b>	<b>42</b>	<b>2207.33</b>

For fibres paper only  
 Inspected on 5/10/2024  
 MOHAMED MUBARIS. K  
 Assistant Engineer  
 LID & EN Section  
 Kappur Gramapanchayat

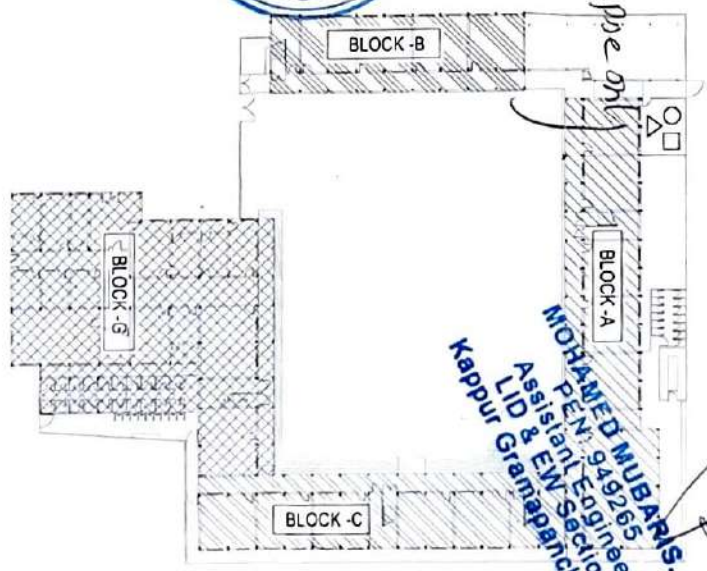

KEY PLAN